

loose plate flange PN 10

[short name: LF-R\\*](#)

drilled, reduced thickness

similar to DIN 2642/ EN 1092-1

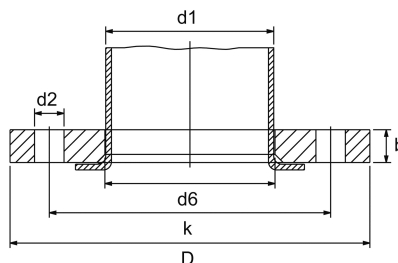

## technical product sheet

| Reihe | DN  | d1    | b  | d6  | D    | k   | d2 | Anz | RG  | Art.-Nr.   |
|-------|-----|-------|----|-----|------|-----|----|-----|-----|------------|
| ISO   | 20  | 26,9  | 10 | 30  | 105  | 75  | 14 | 4   | M12 | LF-026-R10 |
| ISO   | 25  | 33,7  | 10 | 36  | 115  | 85  | 14 | 4   | M12 | LF-033-R10 |
| ISO   | 32  | 42,4  | 10 | 46  | 140  | 100 | 18 | 4   | M16 | LF-042-R10 |
| ISO   | 40  | 48,3  | 10 | 54  | 150  | 110 | 18 | 4   | M16 | LF-048-R10 |
| ISO   | 40  | 48,3  | 15 | 54  | 150  | 110 | 18 | 4   | M16 | LF-048-R15 |
| ISO   | 50  | 60,3  | 10 | 65  | 165  | 125 | 18 | 4   | M16 | LF-060-R10 |
| ISO   | 50  | 60,3  | 15 | 65  | 165  | 125 | 18 | 4   | M16 | LF-060-R15 |
| ISO   | 65  | 76,1  | 10 | 81  | 185  | 145 | 18 | 4   | M16 | LF-076-R10 |
| ISO   | 65  | 76,1  | 15 | 81  | 185  | 145 | 18 | 4   | M16 | LF-076-R15 |
| ISO   | 80  | 88,9  | 10 | 94  | 200  | 160 | 18 | 8   | M16 | LF-088-R10 |
| ISO   | 80  | 88,9  | 15 | 94  | 200  | 160 | 18 | 8   | M16 | LF-088-R15 |
| ISO   | 100 | 114,3 | 10 | 119 | 220  | 180 | 18 | 8   | M16 | LF-114-R10 |
| ISO   | 100 | 114,3 | 15 | 119 | 220  | 180 | 18 | 8   | M16 | LF-114-R15 |
| ISO   | 125 | 139,7 | 12 | 145 | 250  | 210 | 18 | 8   | M16 | LF-139-R12 |
| ISO   | 150 | 168,3 | 12 | 173 | 285  | 240 | 22 | 8   | M20 | LF-168-R12 |
| ISO   | 150 | 168,3 | 15 | 173 | 285  | 240 | 22 | 8   | M20 | LF-168-R15 |
| ISO   | 200 | 219,1 | 12 | 225 | 340  | 295 | 22 | 8   | M20 | LF-219-R12 |
| ISO   | 200 | 219,1 | 15 | 225 | 340  | 295 | 22 | 8   | M20 | LF-219-R15 |
| ISO   | 250 | 273,0 | 15 | 279 | 395  | 350 | 22 | 12  | M20 | LF-273-R15 |
| ISO   | 250 | 273,0 | 20 | 279 | 395  | 350 | 22 | 12  | M20 | LF-273-R20 |
| ISO   | 300 | 323,9 | 15 | 329 | 445  | 400 | 22 | 12  | M20 | LF-323-R15 |
| ISO   | 300 | 323,9 | 20 | 329 | 445  | 400 | 22 | 12  | M20 | LF-323-R20 |
| ISO   | 350 | 355,6 | 15 | 362 | 505  | 460 | 22 | 16  | M20 | LF-355-R15 |
| ISO   | 350 | 355,6 | 20 | 362 | 505  | 460 | 22 | 16  | M20 | LF-355-R20 |
| ISO   | 400 | 406,4 | 15 | 413 | 565  | 515 | 26 | 16  | M24 | LF-406-R15 |
| ISO   | 400 | 406,4 | 20 | 413 | 565  | 515 | 26 | 16  | M24 | LF-406-R20 |
| ISO   | 450 | 457,2 | 15 | 467 | 615  | 565 | 26 | 20  | M24 | LF-457-R15 |
| ISO   | 450 | 457,2 | 20 | 467 | 615  | 565 | 26 | 20  | M24 | LF-457-R20 |
| ISO   | 500 | 508,0 | 15 | 517 | 670  | 620 | 26 | 20  | M24 | LF-508-R15 |
| ISO   | 500 | 508,0 | 20 | 517 | 670  | 620 | 26 | 20  | M24 | LF-508-R20 |
| ISO   | 600 | 610,0 | 15 | 618 | 780  | 725 | 30 | 20  | M27 | LF-610-R15 |
| ISO   | 600 | 610,0 | 20 | 618 | 780  | 725 | 30 | 20  | M27 | LF-610-R20 |
| ISO   | 700 | 711,2 | 20 | 721 | 895  | 840 | 30 | 24  | M27 | LF-711-R20 |
| ISO   | 700 | 711,2 | 25 | 721 | 895  | 840 | 30 | 24  | M27 | LF-711-R25 |
| ISO   | 800 | 813,0 | 25 | 824 | 1015 | 950 | 33 | 24  | M30 | LF-813-R25 |
| ISO   | 800 | 813,0 | 30 | 824 | 1015 | 950 | 33 | 24  | M30 | LF-813-R30 |

| Reihe  | DN  | d1    | b  | d6  | D   | k   | d2 | Anz | RG  | Art.-Nr.   |
|--------|-----|-------|----|-----|-----|-----|----|-----|-----|------------|
| Metric | 50  | 54,0  | 10 | 59  | 165 | 125 | 18 | 4   | M16 | LF-054-R10 |
| Metric | 65  | 69,0  | 10 | 74  | 185 | 145 | 18 | 4   | M16 | LF-069-R10 |
| Metric | 65  | 70,0  | 10 | 75  | 185 | 145 | 18 | 4   | M16 | LF-070-R10 |
| Metric | 80  | 84,0  | 10 | 89  | 200 | 160 | 18 | 8   | M16 | LF-084-R10 |
| Metric | 100 | 104,0 | 15 | 109 | 220 | 180 | 18 | 8   | M16 | LF-104-R15 |
| Metric | 125 | 129,0 | 15 | 134 | 250 | 210 | 18 | 8   | M16 | LF-129-R15 |
| Metric | 150 | 154,0 | 15 | 159 | 285 | 240 | 22 | 8   | M20 | LF-154-R15 |
| Metric | 200 | 204,0 | 15 | 210 | 340 | 295 | 22 | 8   | M20 | LF-204-R15 |
| Metric | 250 | 254,0 | 15 | 260 | 395 | 350 | 22 | 12  | M20 | LF-254-R15 |
| Metric | 300 | 306,0 | 20 | 315 | 445 | 400 | 22 | 12  | M20 | LF-306-R20 |
| Metric | 600 | 608,0 | 20 | 614 | 780 | 725 | 30 | 20  | M27 | LF-608-R20 |
| DIN    | 40  | 44,5  | 10 | 50  | 150 | 110 | 18 | 4   | M16 | LF-044-R10 |
| DIN    | 100 | 108,0 | 10 | 113 | 220 | 180 | 18 | 8   | M16 | LF-108-R10 |
| DIN    | 150 | 159,0 | 15 | 164 | 285 | 240 | 22 | 8   | M20 | LF-159-R15 |

available material: 1.4571, 304L, 316L

Flanges > loose plate flanges > reduced thickness > drilled PN 10