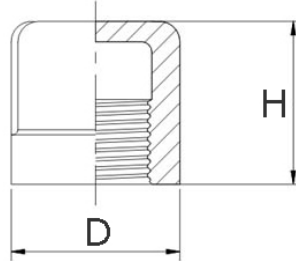

round cap

[short name: KA-R\\*](#)

## technical product sheet

Rp	D	H	kg	Art.-Nr.
1/8"	16	17	0,000	KA-018-RUN
1/4"	19	18	0,000	KA-014-RUN
3/8"	23	18	0,000	KA-038-RUN
1/2"	29	20	0,000	KA-012-RUN
3/4"	34	22	0,000	KA-034-RUN
1"	42	27	0,130	KA-100-RUN
1 1/4"	51	29	0,186	KA-114-RUN
1 1/2"	58	29	0,270	KA-112-RUN
2"	70	32	0,560	KA-200-RUN
2 1/2"	83	39	0,000	KA-212-RUN
3"	100	41	0,000	KA-300-RUN
4"	128	41	0,000	KA-400-RUN

available material: ask

Threaded fittings &gt; fittings &gt; PN 10 (ECO-Line) &gt; caps &gt; round caps

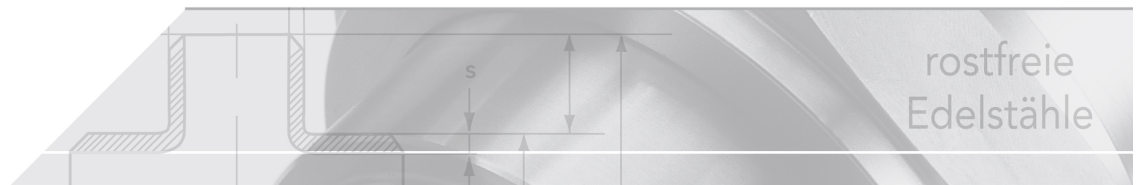

Round cap out of stainless steel

**Threads:**

Whitworth-Pipe threads according to DIN 2999

Type of thread	Version	Code
Inner thread	cylindrical	Rp
Outer thread	tapered	R

**Application:**

For threaded pipes and fittings, sealed using sealing material in the threads.

Connections sealed in the threads are specified in various national and international standards (ISO 7/1