

Rohrschelle, mittelschwer
ähnlich DIN 3567, Form A

Kurzbezeichnung: SCM*

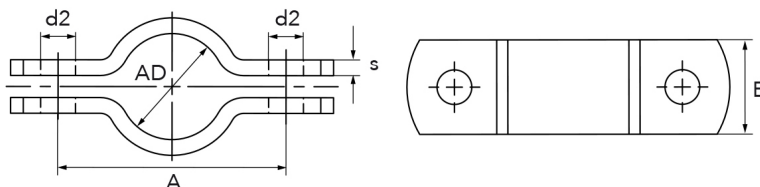

Technisches Produktblatt

| DN | Rohr-AD | B | s | A | d2 | SB | kg | Art.-Nr. |
|-----|---------|----|---|-----|------|--------|--------|------------|
| 15 | 18-19 | 30 | 3 | 50 | 9,0 | M8x25 | 0,080 | SC-018-00M |
| 15 | 21,3 | 30 | 3 | 50 | 11,5 | M10x30 | 0,100 | SC-021-00M |
| 20 | 25,0 | 30 | 3 | 62 | 11,5 | M10x30 | 0,128 | SC-025-00M |
| 20 | 26,9 | 30 | 3 | 66 | 11,5 | M10x30 | 0,128 | SC-026-00M |
| 25 | 28-29 | 30 | 3 | 68 | 11,5 | M10x30 | 0,140 | SC-029-00M |
| 25 | 33,7 | 30 | 3 | 72 | 11,5 | M10x30 | 0,140 | SC-033-00M |
| 32 | 35-36 | 30 | 3 | 76 | 11,5 | M10x30 | 0,155 | SC-036-00M |
| 32 | 38,0 | 30 | 3 | 82 | 11,5 | M10x30 | 0,141 | SC-038-00M |
| 32 | 42,4 | 30 | 3 | 82 | 11,5 | M10x30 | 0,155 | SC-042-00M |
| 40 | 43-45 | 30 | 3 | 84 | 11,5 | M10x30 | 0,162 | SC-044-00M |
| 40 | 48,3 | 30 | 3 | 88 | 11,5 | M10x30 | 0,190 | SC-048-00M |
| 50 | 53-57 | 40 | 4 | 104 | 14,0 | M12x35 | 0,340 | SC-054-00M |
| 50 | 60,3 | 40 | 4 | 108 | 14,0 | M12x35 | 0,400 | SC-060-00M |
| 65 | 68-70 | 40 | 4 | 122 | 14,0 | M12x35 | 0,420 | SC-070-00M |
| 65 | 76,1 | 40 | 4 | 122 | 14,0 | M12x35 | 0,402 | SC-076-00M |
| 80 | 83-85 | 40 | 4 | 136 | 14,0 | M12x35 | 0,440 | SC-084-00M |
| 80 | 88,9 | 40 | 4 | 136 | 14,0 | M12x35 | 0,460 | SC-088-00M |
| 100 | 103-108 | 50 | 5 | 172 | 18,0 | M16x45 | 0,880 | SC-104-00M |
| 100 | 114,3 | 50 | 5 | 178 | 18,0 | M16x45 | 1,000 | SC-114-00M |
| 125 | 128-133 | 50 | 5 | 196 | 18,0 | M16x45 | 0,520 | SC-129-00M |
| 125 | 139,7 | 50 | 5 | 204 | 18,0 | M16x45 | 1,120 | SC-139-00M |
| 150 | 153-155 | 50 | 6 | 222 | 18,0 | M16x45 | 1,440 | SC-154-00M |
| 150 | 159,0 | 50 | 6 | 222 | 18,0 | M16x45 | 1,437 | SC-159-00M |
| 150 | 168,3 | 50 | 6 | 232 | 18,0 | M16x45 | 1,520 | SC-168-00M |
| 200 | 204-206 | 50 | 6 | 280 | 18,0 | M16x45 | 1,840 | SC-204-00M |
| 200 | 219,1 | 50 | 6 | 284 | 18,0 | M16x45 | 1,900 | SC-219-00M |
| 250 | 254-256 | 60 | 6 | 342 | 23,0 | M20x50 | 2,660 | SC-254-00M |
| 250 | 273,0 | 60 | 6 | 348 | 23,0 | M20x50 | 2,840 | SC-273-00M |
| 300 | 304-308 | 60 | 6 | 392 | 23,0 | M20x50 | 3,060 | SC-304-00M |
| 300 | 323,9 | 60 | 6 | 398 | 23,0 | M20x50 | 3,240 | SC-323-00M |
| 350 | 354-358 | 60 | 6 | 444 | 23,0 | M20x50 | 3,500 | SC-355-00M |
| 400 | 404-410 | 70 | 8 | 498 | 27,0 | M24x60 | 13,360 | SC-406-00M |
| 450 | 454-460 | 70 | 8 | 548 | 27,0 | M24x60 | 8,660 | SC-457-00M |
| 500 | 506-512 | 70 | 8 | 614 | 27,0 | M24x60 | 7,320 | SC-508-00M |
| 600 | 606-612 | 70 | 8 | 710 | 27,0 | M24x60 | 11,210 | SC-609-00M |
| 700 | 706-712 | 70 | 8 | 812 | 27,0 | M24x60 | 0,000 | SC-711-00M |

| DN | Rohr-AD | B | s | A | d2 | SB | kg | Art.-Nr. |
|-----|---------|----|----|------|------|--------|-------|------------|
| 800 | 806-813 | 70 | 8 | 913 | 27,0 | M24x60 | 0,000 | SC-812-00M |
| 900 | 908-916 | 90 | 10 | 1030 | 27,0 | M30x70 | 0,000 | SC-914-00M |

Verfügbare Werkstoffe: 1.4301, V4A

Montagematerial > Rohrschellen > mittelschwer (ähnl. DIN)

*Tipp: Die Eingabe der [Kurzbezeichnung](#) in das Suchfeld auf unserer Website ermöglicht Ihnen den Direktaufruf einer Artikelgruppe. Alternativ [hier klicken](#)