

Redukční tvarovka T 150 lbs
(PN 10)

[zkratka označení: NPT-RT*](#)

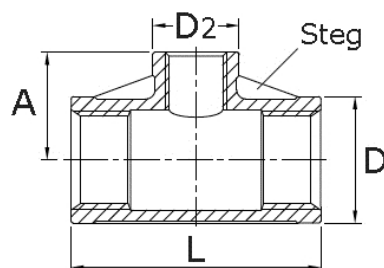

technický list výrobku

| NPT | NPT2 | D | D2 | A | L | V-Steg |
|--------|--------|------|------|------|-------|--------|
| 1/4" | 1/8" | 18,5 | 15,0 | 18,5 | 39,0 | Ja |
| 3/8" | 1/8" | 22,0 | 18,5 | 21,0 | 44,0 | Ja |
| 3/8" | 1/4" | 22,0 | 18,5 | 21,5 | 44,0 | Ja |
| 1/2" | 1/8" | 28,0 | 15,0 | 23,5 | 53,5 | Ja |
| 1/2" | 1/4" | 28,0 | 18,5 | 23,0 | 53,5 | Ja |
| 1/2" | 3/8" | 28,0 | 22,0 | 25,0 | 53,5 | Ja |
| 3/4" | 1/8" | 33,0 | 15,0 | 26,0 | 59,0 | Ja |
| 3/4" | 1/4" | 33,0 | 18,5 | 25,5 | 59,0 | Ja |
| 3/4" | 3/8" | 33,0 | 22,0 | 27,5 | 59,0 | Ja |
| 3/4" | 1/2" | 33,0 | 28,0 | 30,5 | 59,0 | Ja |
| 1" | 1/4" | 40,5 | 18,5 | 30,0 | 70,0 | Ja |
| 1" | 3/8" | 40,5 | 22,0 | 31,5 | 70,0 | Ja |
| 1" | 1/2" | 40,5 | 27,0 | 34,0 | 70,0 | Ja |
| 1" | 3/4" | 40,5 | 33,0 | 36,0 | 70,0 | Ja |
| 1 1/4" | 3/8" | 49,0 | 22,0 | 36,5 | 86,0 | Ja |
| 1 1/4" | 1/2" | 49,0 | 28,0 | 38,0 | 86,0 | Ja |
| 1 1/4" | 3/4" | 49,0 | 33,0 | 40,5 | 86,0 | Ja |
| 1 1/4" | 1" | 49,0 | 40,5 | 42,0 | 86,0 | Ja |
| 1 1/2" | 1/2" | 56,0 | 28,0 | 42,0 | 89,0 | Ja |
| 1 1/2" | 3/4" | 56,0 | 33,0 | 44,0 | 89,0 | Ja |
| 1 1/2" | 1" | 56,0 | 40,5 | 46,0 | 89,0 | Ja |
| 1 1/2" | 1 1/4" | 56,0 | 49,0 | 49,0 | 89,0 | Ja |
| 2" | 3/4" | 68,0 | 33,0 | 49,0 | 108,0 | Ja |
| 2" | 1" | 68,0 | 40,5 | 53,0 | 108,0 | Ja |
| 2" | 1 1/4" | 68,0 | 49,0 | 55,5 | 108,0 | Ja |
| 2" | 1 1/2" | 68,0 | 56,0 | 56,5 | 108,0 | Ja |

dostupné jakosti: na poptávku

Fitinky závitové > Fitinky > PN 10 (ECO-Line) > ... se závitem NPT > tvarovky T, Y, X > red. tvarovka T