

union, conical socket welding  
high-pressure fitting 3000 lbs  
ASTM A 182

[short name: SWV\\*](#)

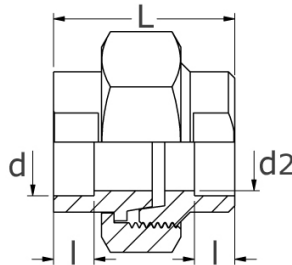

#### technical product sheet

Zoll	d	l	d2	L	Art.-Nr.
1/4"	14,4	9,5	9,5	45	ANSI-SWVK-014-3000-N
3/8"	17,6	9,5	12,5	46	ANSI-SWVK-038-3000-N
1/2"	21,8	9,5	16,0	49	ANSI-SWVK-012-3000-N
3/4"	27,2	12,5	21,0	57	ANSI-SWVK-034-3000-N
1"	34,1	12,5	26,5	62	ANSI-SWVK-100-3000-N
1 1/4"	42,9	12,5	35,0	72	ANSI-SWVK-114-3000-N
1 1/2"	49,0	12,5	41,0	77	ANSI-SWVK-112-3000-N
2"	61,5	16,0	52,5	86	ANSI-SWVK-200-3000-N

available material: ask

Threaded fittings > unions > conical seat > ASME 3000 lbs > socket welding