

2-piece ball valve F/F  
with spring return  
full bore

[short name: K2FR\\*](#)

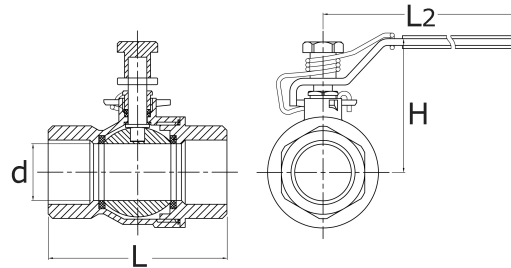

### technical product sheet

DN	G	d	L	H	L2	Cv	PN	Art.-Nr.
8	1/4"	11,6	60,0	51,0	95	6,6	130	K2FR-014-4
10	3/8"	12,7	60,0	51,0	95	7,9	130	K2FR-038-4
15	1/2"	15,0	75,0	53,0	95	11,2	130	K2FR-012-4
20	3/4"	20,0	80,0	59,5	60	21,0	130	K2FR-034-4
25	1"	25,0	90,0	73,0	73	35,0	130	K2FR-100-4
32	1 1/4"	32,0	110,0	79,0	79	57,0	64	K2FR-114-4
40	1 1/2"	38,0	120,0	90,5	90	80,0	64	K2FR-112-4
50	2"	50,0	140,0	98,5	99	148,0	64	K2FR-200-4

available material: V4A

Industrial valves > ball valves > threaded ends > 2-piece, full bore > with spring return

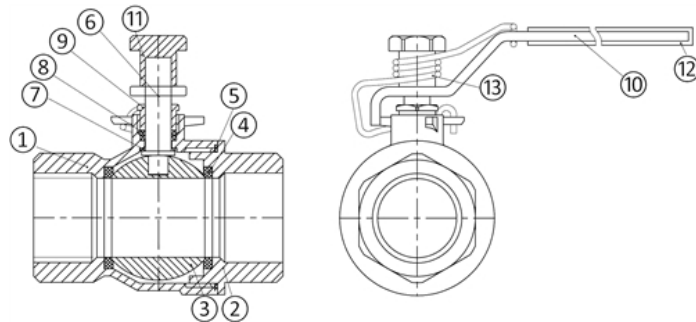

### Parts list

No.	Designation	Material
1.	Housing	V4A (CF8M/ 1.4408)
2.	Cap	V4A (CF8M/ 1.4408)
3.	Ball	V4A (CF8M/ 1.4408)
4.	Seat seal (2x)	PTFE
5.	Housing seal	PTFE
6.	Control shaft	V4A (CF8M/ 1.4408)
7.	Shaft seal	PTFE
8.	Stem packing seal (2x)	PTFE
9.	Stem packing	V2A (AISI 304)
10.	Handle	V2A (AISI 304)
11.	Stem nut	V2A (AISI 304)
12.	Hand sleeve	PVC
13.	Spring	V2A (AISI 304)

Features	Version
Medium	Water - Oil - Gas
Thread	Inner thread acc. to DIN ISO 228
Pressure level	PN 130 from 1/2" to 1"
	PN 64 from 1 1/2" to 2"
Housing	two-piece design

### Information

The opening takes place against the spring force. Closing must be done with manual assistance.

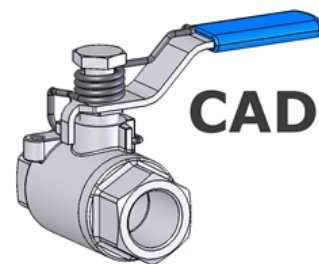
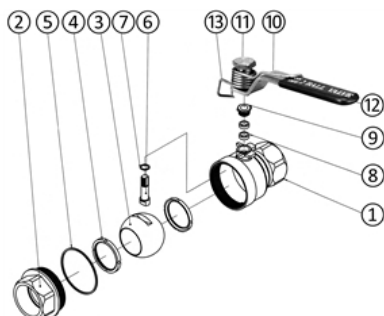

als 3D-Modell verfügbar