

light pipe clamp

[short name: SCL\\*](#)

similar to DIN 3567, shape A  
(without screws and nuts)

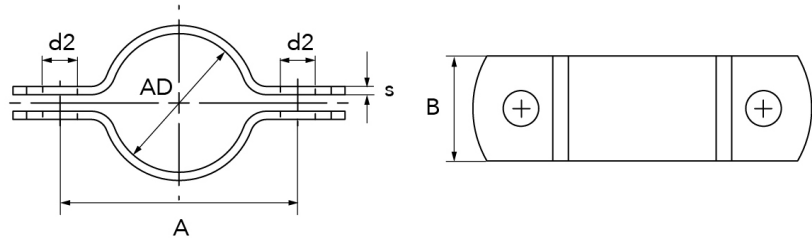

### technical product sheet

DN	Rohr-AD	B	s	d2	A	kg	Art.-Nr.
6	10,2	20	2,0	6,5	27	0,025	SC-010-00L
8	13,5	20	2,0	6,5	31	0,038	SC-013-00L
10	17,2	20	2,0	6,5	43	0,037	SC-017-00L
15	21,3	25	2,0	8,5	43	0,060	SC-021-00L
20	26,9	25	2,0	8,5	48	0,068	SC-026-00L
25	33,7	25	2,0	8,5	58	0,068	SC-033-00L
32	42,4	30	2,0	8,5	70	0,151	SC-042-00L
40	44,5	30	2,0	8,5	72	0,000	SC-044-00L
40	48,3	30	2,0	8,5	83	0,400	SC-048-00L
50	54,0	30	2,0	8,5	90	0,100	SC-054-00L
50	60,3	30	2,0	8,5	94	0,120	SC-060-00L
65	76,1	35	2,5	8,5	116	0,245	SC-076-00L
80	88,9	35	2,5	8,5	130	0,280	SC-088-00L
100	114,3	35	3,0	8,5	158	0,360	SC-114-00L
125	139,7	35	3,0	11,0	190	0,440	SC-139-00L
150	168,3	35	3,0	11,0	220	0,500	SC-168-00L
200	219,1	35	3,0	11,0	255	0,669	SC-219-00L
250	273,0	35	3,0	11,0	335	0,728	SC-273-00L

available material: 1.4301

Installation supplies > pipe clamps > light design > shape A, acc. DIN 3567