

45° bend type 2
($r=1 \times D$) DIN 2605 welded

[short name: 45.2.W*](#)

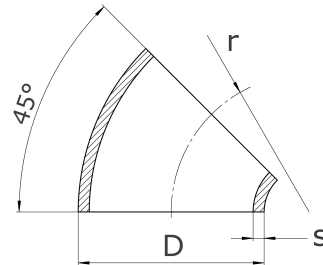

technical product sheet

D	s	r	Typ	kg	Art.-Nr.
104,0	2,0	100,0	Einnahtausführung	0,36345B2-104X20-N-W1	
114,3	2,0	102,0	aus 2 Schalen verschweißt	0,52145B2-114X20-2-W2	
204,0	2,0	200,0	aus 2 Schalen verschweißt	0,00045B2-204X20-1-W2	

available material: ask

Butt welding fittings > bends > welded > type 2D > 45°, other dimensions