

elbow 45° sw, 3000 lbs  
high pressure-fitting  
ASME B 16.11, ASTM-A 182

short name: [SW45\\*](#)

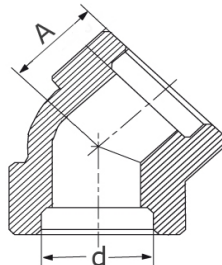

### technical product sheet

Zoll	d	A	Art.-Nr.
1/4"	14,4	16	ANSI-SW45-014-3000-N
3/8"	17,8	17	ANSI-SW45-038-3000-N
1/2"	22,0	22	ANSI-SW45-012-3000-N
3/4"	27,4	27	ANSI-SW45-034-3000-N
1"	34,1	28	ANSI-SW45-100-3000-N
1 1/4"	42,9	31	ANSI-SW45-114-3000-N
1 1/2"	49,0	34	ANSI-SW45-112-3000-N
2"	61,5	43	ANSI-SW45-200-3000-N

available material: ask

Butt welding fittings > ANSI / ASME > socket welding fittings > elbows 45°