

T-piece reduced EN 10253-3
with welded branch

[short name: RTEA*](#)

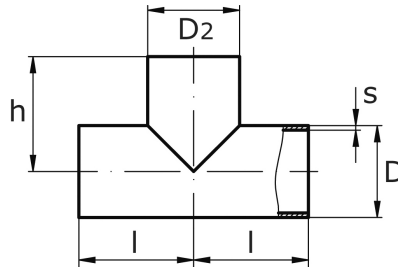
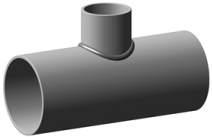

technical product sheet

Art	D	D2	s	s2	L	l	h
ISO >	76,1	28,0	2,0	2,0	152	76	64
ISO >	76,1	35,0	2,0	2,0	152	76	64
ISO >	76,1	54,0	2,0	2,0	152	76	70
ISO >	88,9	28,0	2,0	2,0	172	76	64
ISO >	88,9	54,0	2,0	2,0	172	86	76
ISO >	88,9	57,0	3,0	3,0	172	86	76
ISO >	88,9	70,0	2,0	2,0	172	86	83
ISO >	139,7	104,0	2,0	2,0	248	124	117
ISO >	168,3	108,0	2,0	2,0	286	143	130
ISO >	168,3	133,0	2,5	2,5	286	145	130
ISO >	219,1	108,0	2,0	2,0	356	178	156
ISO >	219,1	108,0	3,0	3,0	356	178	156
ISO >	219,1	108,0	4,0	4,0	356	178	156
ISO >	219,1	133,0	2,0	2,0	356	178	162
ISO >	219,1	154,0	2,0	2,0	356	178	168
ISO >	219,1	159,0	2,0	2,0	356	178	168
ISO >	219,1	159,0	3,0	3,0	356	178	168
ISO >	219,1	159,0	4,0	4,0	356	178	168
ISO >	273,0	108,0	3,0	3,0	432	216	182
ISO >	273,0	133,0	3,0	3,0	432	216	190
ISO >	323,9	104,0	3,0	2,0	508	254	210
ISO >	323,9	108,0	3,0	3,0	508	254	210
ISO >	323,9	204,0	3,0	2,0	508	254	229
ISO >	355,6	256,0	3,0	3,0	560	280	257
ISO >	355,6	306,0	3,0	3,0	558	279	255
ISO >	406,0	204,0	3,0	3,0	610	305	273
ISO >	406,0	206,0	3,0	3,0	610	350	273
ISO >	406,0	256,0	3,0	3,0	610	305	283
ISO >	406,0	306,0	3,0	3,0	610	305	295
ISO >	406,4	304,0	2,0	2,0	610	305	295
ISO >	406,4	304,0	4,0	4,0	610	305	295
ISO >	508,0	204,0	3,0	3,0	762	381	324
ISO >	508,0	304,0	4,0	4,0	762	381	324
ISO >	508,0	354,0	4,0	4,0	762	381	324
ISO >	609,6	304,0	3,0	3,0	864	432	395
ISO >	609,6	306,0	3,0	3,0	864	432	395

Art	D	D2	s	s2	L	l	h
> ISO	54,0	33,7	2,0	2,0	128	51	51
> ISO	54,0	42,4	2,0	2,0	128	64	57
> ISO	57,0	21,3	2,0	2,0	128	64	57
> ISO	57,0	33,7	2,0	2,0	128	64	57
> ISO	70,0	33,7	2,0	2,0	152	76	54
> ISO	70,0	42,4	2,0	2,0	152	76	64
> ISO	70,0	48,3	2,0	2,0	152	76	67
> ISO	84,0	60,3	2,0	2,0	172	86	76
> ISO	104,0	21,3	2,0	2,0	210	105	66
> ISO	104,0	33,7	2,0	2,0	210	105	78
> ISO	104,0	48,3	2,0	2,0	210	150	83
> ISO	104,0	60,3	2,0	2,0	210	150	89
> ISO	104,0	88,9	2,0	2,0	210	150	98
> ISO	108,0	42,4	2,0	2,0	210	105	81
> ISO	108,0	60,3	2,0	2,0	210	105	89
> ISO	108,0	60,3	3,0	3,0	210	105	89
> ISO	108,0	76,1	2,0	2,0	210	105	95
> ISO	108,0	88,9	2,0	2,0	210	105	98
> ISO	108,0	88,9	3,0	3,0	210	105	98
> ISO	129,0	60,3	2,0	2,0	248	124	105
> ISO	129,0	88,9	2,0	2,0	248	124	111
> ISO	133,0	60,3	2,0	2,0	248	124	105
> ISO	133,0	88,9	2,0	2,0	248	124	111
> ISO	133,0	88,9	3,0	3,0	248	124	111
> ISO	133,0	88,9	4,0	4,0	248	124	111
> ISO	133,0	114,3	2,0	2,0	248	124	114
> ISO	154,0	48,3	2,0	2,0	286	143	110
> ISO	154,0	60,3	2,0	2,0	286	143	111
> ISO	154,0	88,9	2,0	2,0	286	143	124
> ISO	154,0	114,3	2,0	2,0	286	143	130
> ISO	159,0	57,0	3,0	3,0	286	143	115
> ISO	159,0	60,3	2,0	2,0	286	143	115
> ISO	159,0	76,1	2,0	2,0	286	143	121
> ISO	159,0	88,9	3,0	3,0	286	143	124
> ISO	159,0	114,3	2,0	2,0	286	143	130
> ISO	204,0	60,3	2,0	2,0	356	178	136
> ISO	204,0	88,9	2,0	2,0	356	178	152
> ISO	256,0	219,1	3,0	3,0	432	216	203
> ISO	304,0	60,3	2,0	2,0	508	254	186
> ISO	304,0	88,9	2,0	2,0	508	254	206
> ISO	306,0	88,9	3,0	3,0	508	254	195
> ISO	306,0	114,3	3,0	3,0	508	254	201
> ISO	306,0	168,3	3,0	3,0	508	254	220
> ISO	306,0	273,0	3,0	3,0	508	254	232

available material: 1.4571

Butt welding fittings > T- X- Y- pieces > welded, reduced > DIN EN 10253-3 > welded branch > ISO <> other

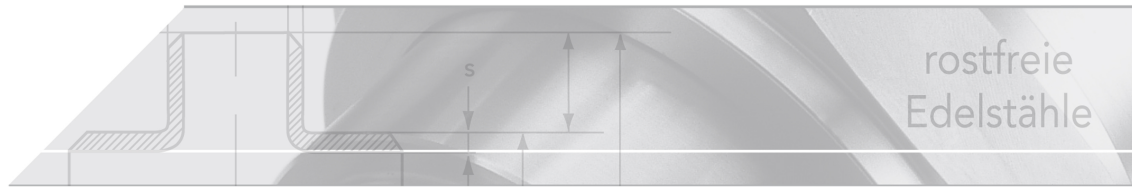

T-pieces

with reduced branch

Version

acc. to EN 10253-3 (old DIN 2615)

W (welded) - made of welded tube or made of sheet
with butt joint welded branch

material: 1.4307/304L - 1.4571 - 1.4404/316L

certificate primary material acc. to EN 10204/3.1

from in-house production

Tolerances

Limit deviations for wall thickness [s]

$\leq 4 \text{ mm}$ - 12,5 % / + 20 %

$> 4 \text{ mm}$ - 12,5 % / + 15 %

Limit deviations for diameter [D]

$\pm 1,0 \%$ or $\pm 0,5 \text{ mm}$, the relevant higher value applies (EN tolerance class D2)

Limit deviations for dimensions [l]

$\leq 219,1 = \pm 2 \text{ mm}$

$\leq 406,4 = \pm 3 \text{ mm}$

Limit deviations for shaped piece geometry [X]

$X = 1 \%$ of the outside- \emptyset or 1 mm, the relevant higher value applies

