

union conical, M/BW
(butt weld end on insert part)

short name: [VVK.AS*](#)

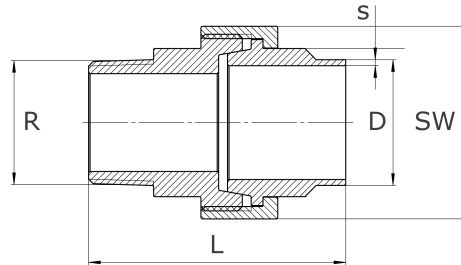

technical product sheet

R	D	s	L	SW	kg	Art.-Nr.
1/4"	13,5		50	27	0,000	VK-014-0AS
3/8"	17,2		54	32	0,147	VK-038-0AS
1/2"	21,3		58	41	0,290	VK-012-0AS
3/4"	26,9		72	50	0,440	VK-034-0AS
1"	33,7		67	55	0,580	VK-100-0AS
1 1/4"	42,4	2,0	87	65	0,772	VK-114-0AS
1 1/2"	48,3		83	75	0,721	VK-112-0AS
2"	60,3		90	85	1,122	VK-200-0AS

available material: ask

Threaded fittings > unions > conical seat > PN 50/ 100 > "inches"- union nuts > M / BW



Union, M / BW
conical seat

Description

Whitworth-Pipe thread acc. to DIN 2999 (R, BSPT)

Parts that come into contact with media: material No. 1.4571 union nut V2A or 1.4571

Turned design, made from a solid material

Welding end on the inserted part

optional: cast union nut (V4A)

optional: flats at an extra charge