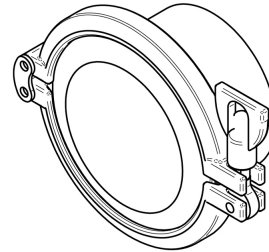
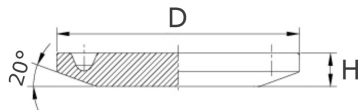

clamp blind flange DIN 32676

[short name: TCBD\\*](#)

## technical product sheet

D	DN	DIN-DN	ISO-DN	ASME	H	kg	Art.-Nr.
25,0	6	6-8	6-10	1/4"-3/4"	4,75	0,014	TCBD-006-N
34,0	10	10-20	-	-	6,35	0,040	TCBD-010-N
50,5	25	25-40	15-25	1"-1,5"	6,35	0,078	TCBD-025-N
64,0	50	50	32-40	2"	6,35	0,135	TCBD-050-N
77,5	2,5"	-	50	2,5"	6,35	0,204	TCBD-060-N
91,0	65	65	65	3"	6,35	0,300	TCBD-065-N
106,0	80	80	80	-	6,35	0,400	TCBD-080-N
119,0	100	100	-	4"	8,00	0,500	TCBD-100-N
130,0	4,5"	-	100	4,5"	8,00	0,741	TCBD-114-N
155,0	125	125	125	5,5"	11,00	1,618	TCBD-125-N
183,0	150	150	150	6,6"	12,00	2,320	TCBD-150-N
233,5	200	200	1649	8,6"	12,00	4,271	TCBD-200-N

available material: V4A

Systems &gt; clamp connections &gt; clamp blind flanges

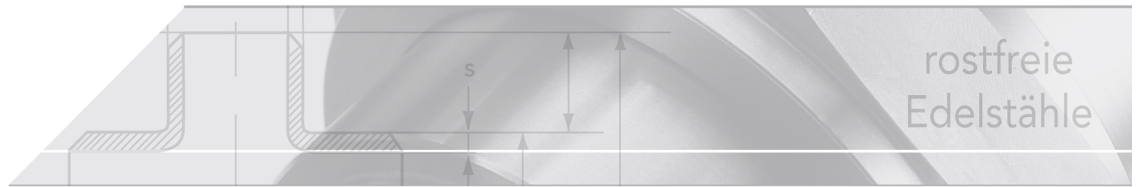

## Clamp connections DIN 32676

### Fields of application

The clamp connections proven in Europe and overseas for many years can be used especially for liquid media, for example for milk, beer, wine, fruit juice, and similar liquids. Popular areas of application are the food, beverage, chemicals, pharmaceuticals, and cosmetics industries as well as in biotechnology, filter technology, and water treatment technology.

### Mounting

During assembly, the clamp seal is placed on one of the two clamp sleeves so that the outer edge of the seal wraps around the flange of the clamp sleeve. Then you place the other clamp sleeve on the seal. The clamp sleeve and the seal are therefore coaxially centered. After that, the clamp is placed around the flange of the clamp sleeve and closed (optionally available with safety lock). The seal deforms in this case so that a smoother passage free of dead space and a sealed connection are created.

