

male part adapter
no. 228, DIN 11851

[short name: 228*](#)

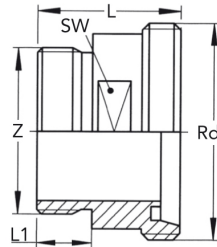

technical product sheet

DN	Zoll	Rd	SW	L	L1	kg	Art.-Nr.
10	G 3/8"	28x1/8"	19	40	14	0,074	GL-228-010
15	G 1/2"	34x1/8"	24	40	14	0,091	GL-228-015
20	G 3/4"	44x1/6"	30	42	14	0,155	GL-228-020
25	G 1"	52x1/6"	36	48	20	0,280	GL-228-025
32	G 1 1/4"	58x1/6"	46	48	20	0,305	GL-228-032
40	G 1 1/2"	65x1/6"	50	50	20	0,372	GL-228-040
50	G 2"	78x1/6"	60	52	20	0,556	GL-228-050
65	G 2 1/2"	95x1/6"	75	56	22	0,732	GL-228-065
80	G 3"	110x1/4"	90	66	25	1,015	GL-228-080
100	G 4"	130x1/4"	105	72	30	1,500	GL-228-100

available material: V2A

Beverage fittings > unions > male parts > male to BSP male



Male part adapter

for the food industry

Materials

V2A

AISI 304/ 304L - 1.4301/ 1.4306, 1.4307

V4A

AISI 316L - 1.4404