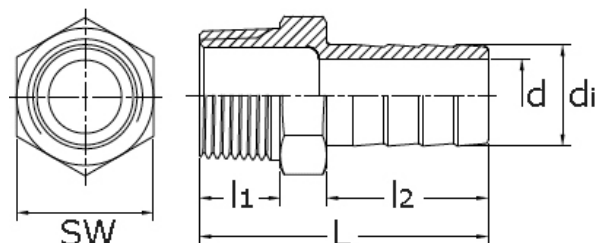

hadicové nástavce

[zkratka označení: NPT.TUE*](#)

technický list výrobku

NPT	d	di	l1	l2	L	SW	SF
1/8"	3,0	6,0	10,0	19,0	34,0	12,5	6-kant
1/4"	4,0	8,0	11,5	25,0	43,0	15,0	6-kant
3/8"	5,0	10,0	13,0	29,5	49,0	19,0	6-kant
1/2"	7,0	13,0	15,0	33,0	56,5	23,0	6-kant
3/4"	15,0	20,0	15,5	34,0	60,0	28,0	6-kant
1"	19,5	25,0	19,0	39,0	69,0	37,0	6-kant
1 1/4"	26,5	32,0	22,0	37,0	70,0	45,0	6-kant
1 1/2"	33,5	40,0	22,0	47,5	80,0	50,0	6-kant
2"	44,0	51,5	22,5	53,5	88,0	62,0	6-kant
2 1/2"	54,0	63,5	29,5	65,0	108,0	79,0	6-kant
3"	68,0	76,5	27,0	68,0	110,0	91,5	6-kant
4"	91,0	102,0	30,5	74,0	120,0	117,0	6-kant

dostupné jakosti: na poptávku

[Fitinky závitové](#) > [fitinky](#) > [PN 10 \(ECO-Line\)](#) > ... se závitem NPT > [hadicové nástavce](#) > šestihran