

union flat, F/F
with PTFE seal

[short name: LR131*](#)

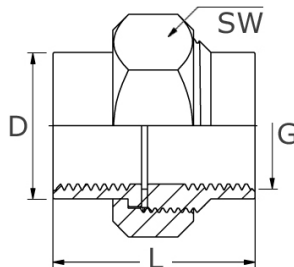

technical product sheet

G	t	L	D	PN	SW	Mutter	kg	Art.-Nr.
1/8"	12	32	17,0	100	27	M22x1,5	0,090	VFII-018LR131
1/4"	12	32	17,0	100	30	M22x1,5	0,092	VFII-014LR131
3/8"	14	38	20,5	100	30	M26x1,5	0,090	VFII-038LR131
1/2"	15	41	24,5	100	36	M30x1,5	0,130	VFII-012LR131
3/4"	17	47	31,0	100	42	M38x1,5	0,190	VFII-034LR131
1"	20	53	38,0	100	50	M45x2	0,300	VFII-100LR131
1 1/4"	22	57	47,0	64	60	M54x2	0,430	VFII-114LR131
1 1/2"	23	63	54,0	64	68	M62x2	0,580	VFII-112LR131
2"	27	72	66,5	64	86	M75x2	0,992	VFII-200LR131
2 1/2"	31	80	98,0	40	128	3 1/2"	3,400	VFII-212LR131
3"	31	80	98,0	40	128	4"	2,450	VFII-300LR131

available material: 1.4404

Threaded fittings > unions > flat seat > PN 50/ 100 > LR-131

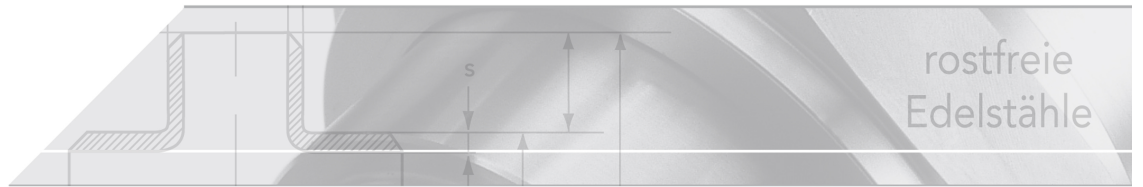

Coupling

LR-131

- > manufactured from solid material – „threaded version“
- > material 1.4404/ AISI 316L
- > flat sealing, incl. O-ring made of PTFE
- > BSP thread according to ISO 228/1; optional with NPT thread
- > wrench surface of the nut: to DN 1" 6-sided; DN 1 1/4" and higher 8-sided

type selection

Property	LR-131	R-134*
Series	heavy	light
Pressure level	PN 100	PN 40
kit system	No	Yes

* = If you use a seal, the conic coupling becomes a flat sealing coupling

