

hexagon hose nozzle
conical male thread

short name: [R.144*](#)

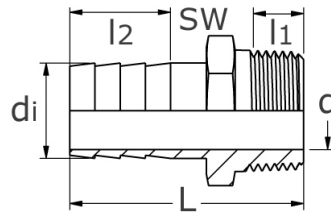
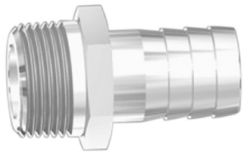

technical product sheet

R	di	d	L	l1	l2	SW	PN
1/8"	6,5	3,5	36	10,0	17,5	14	100
1/8"	8,5	4,5	36	10,0	17,5	14	100
1/8"	11,0	7,0	36	10,0	17,5	14	100
1/4"	6,5	3,5	40	11,0	20,0	14	100
1/4"	8,5	4,5	40	11,0	20,0	14	100
1/4"	11,0	7,0	40	11,0	20,0	14	100
1/4"	14,0	10,0	40	11,0	20,0	14	100
1/4"	17,0	13,0	40	11,0	20,0	14	100
1/4"	19,0	15,0	40	11,0	20,0	14	100
3/8"	8,5	4,5	42	12,5	20,0	19	100
3/8"	11,0	7,0	42	12,5	20,0	19	100
3/8"	14,0	10,0	42	12,5	20,0	19	100
3/8"	17,0	13,0	42	12,5	20,0	19	100
3/8"	19,0	15,0	42	12,5	20,0	19	100
1/2"	11,0	7,0	48	15,0	25,0	22	100
1/2"	14,0	10,0	48	15,0	25,0	22	100
1/2"	17,0	13,0	48	15,0	25,0	22	100
1/2"	19,0	15,0	48	15,0	25,0	22	100
1/2"	21,0	16,0	48	15,0	25,0	22	100
3/4"	11,0	7,0	56	16,5	25,0	30	100
3/4"	14,0	10,0	56	16,5	25,0	30	100
3/4"	17,0	13,0	56	16,5	25,0	30	100
3/4"	21,0	16,0	56	16,5	25,0	30	100
3/4"	26,0	21,0	56	16,5	25,0	30	100
1"	14,0	10,0	65	19,0	35,0	36	100
1"	17,0	13,0	65	19,0	35,0	36	100
1"	21,0	16,0	65	19,0	35,0	36	100
1"	26,0	21,0	65	19,0	35,0	36	100
1"	33,0	25,0	65	19,0	35,0	36	100
1 1/4"	26,0	21,0	75	23,5	40,0	46	64
1 1/4"	33,0	25,0	75	23,5	40,0	46	64
1 1/4"	39,0	31,0	75	23,5	40,0	46	64
1 1/2"	41,0	32,0	78	21,5	40,0	50	64
2"	46,0	38,0	96	25,8	40,0	65	64
2"	51,0	42,0	96	25,8	40,0	65	64

available material: 1.4404

Threaded fittings > fittings > PN 50/ 100 > nozzles > R-144

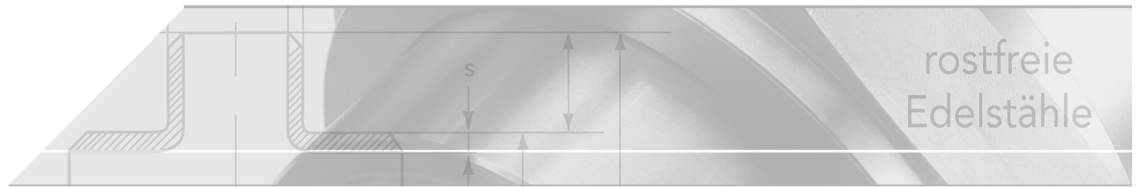

Threaded hose nipple made of stainless steel

Threads:

Whitworth-pipe threads according to DIN 2999

Type of thread	Version	Code
female thread	cylindrical	Rp
male thread	tapered	R

Application:

For threaded pipes and fittings, sealed using sealing material in the threads. Connections sealed in the threads are specified in various national and international standards (ISO 7/1, BS 21, DIN 2999).