

straight male stud coupling
DIN 2353, EN ISO 8434-1
sealing edge form B

[short name: GE.G*](#)

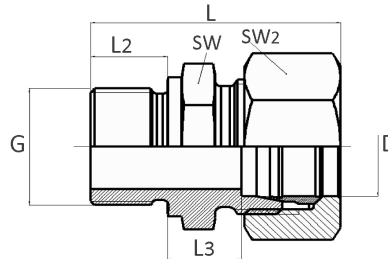

technical product sheet

Reihe	G	D	PN	L	L2	SW	SW2	kg	Art.-Nr.
leicht	1/8"	6	315	31,0	8,5	14	14	0,025	2353-GE06LG01
leicht	1/8"	8	315	31,0	8,5	14	17	0,035	2353-GE08LG01
leicht	1/8"	10	315	33,0	10,5	17	19	0,050	2353-GE10LG01
leicht	1/8"	12	315	34,0	11,5	19	22	0,053	2353-GE12LG01
leicht	1/4"	6	315	37,0	10,0	19	14	0,042	2353-GE06LG02
leicht	1/4"	8	315	37,0	10,0	19	17	0,047	2353-GE08LG02
leicht	1/4"	10	315	38,0	11,0	19	19	0,052	2353-GE10LG02
leicht	1/4"	12	315	39,0	12,0	19	22	0,060	2353-GE12LG02
leicht	1/4"	15	315	40,0	14,0	24	27	0,097	2353-GE15LG02
leicht	3/8"	6	315	38,0	11,5	22	14	0,057	2353-GE06LG03
leicht	3/8"	8	315	38,0	11,5	22	17	0,058	2353-GE08LG03
leicht	3/8"	10	315	39,0	12,5	22	19	0,062	2353-GE10LG03
leicht	3/8"	12	315	39,0	12,5	22	22	0,072	2353-GE12LG03
leicht	3/8"	15	315	41,0	13,5	24	27	0,100	2353-GE15LG03
leicht	3/8"	18	315	41,5	14,0	27	32	0,140	2353-GE18LG03
leicht	3/8"	22	160	44,0	16,5	32	36	0,170	2353-GE22LG03
leicht	1/2"	6	315	41,0	12,0	27	14	0,096	2353-GE06LG04
leicht	1/2"	8	315	41,0	12,0	27	17	0,085	2353-GE08LG04
leicht	1/2"	10	315	42,0	13,0	27	19	0,091	2353-GE10LG04
leicht	1/2"	12	315	42,0	13,0	27	22	0,100	2353-GE12LG04
leicht	1/2"	15	315	43,0	14,0	27	27	0,119	2353-GE15LG04
leicht	1/2"	18	315	45,0	14,5	27	32	0,140	2353-GE18LG04
leicht	1/2"	22	160	47,0	16,5	32	36	0,190	2353-GE22LG04
leicht	1/2"	28	160	48,0	17,5	41	41	0,267	2353-GE28LG04
leicht	3/4"	12	315	45,0	14,0	32	22	0,150	2353-GE12LG06
leicht	3/4"	15	315	46,0	15,0	32	27	0,173	2353-GE15LG05
leicht	3/4"	18	315	47,0	14,5	32	32	0,160	2353-GE18LG06
leicht	3/4"	22	160	49,0	16,5	32	36	0,195	2353-GE22LG06
leicht	3/4"	28	160	50,0	17,5	41	41	0,272	2353-GE28LG06
leicht	1"	15	315	49,0	16,5	41	27	0,240	2353-GE15LG08
leicht	1"	18	315	51,0	18,0	41	32	0,310	2353-GE18LG08
leicht	1"	22	160	51,5	17,5	41	36	0,287	2353-GE22LG08
leicht	1"	28	160	52,0	17,5	41	41	0,270	2353-GE28LG08
leicht	1"	35	160	57,0	17,5	46	50	0,417	2353-GE35LG08
leicht	1 1/4"	28	160	55,0	18,3	50	41	0,432	2353-GE28LG10
leicht	1 1/4"	35	160	59,0	17,5	50	50	0,453	2353-GE35LG10

Reihe	G	D	PN	L	L2	SW	SW2	kg	Art.-Nr.
leicht	1 1/4"	42	160	62,0	19,0	55	60	0,592	2353-GE42LG10
leicht	1 1/2"	35	160	63,0	19,5	55	50	0,604	2353-GE35LG12
leicht	1 1/2"	42	160	64,0	19,0	55	60	0,620	2353-GE42LG12
schwer	1/8"	6	630	35,0	12,5	14	17	0,000	2353-GE06SG01
schwer	1/8"	8	630	36,0	13,0	17	19	0,000	2353-GE08SG01
schwer	1/8"	12	630	39,0	13,5	22	24	0,000	2353-GE12SG01
schwer	1/4"	6	630	40,0	13,0	19	17	0,060	2353-GE06SG02
schwer	1/4"	8	630	42,0	15,0	19	19	0,063	2353-GE08SG02
schwer	1/4"	10	630	43,0	14,5	19	22	0,078	2353-GE10SG02
schwer	1/4"	12	630	45,0	16,5	22	24	0,099	2353-GE12SG02
schwer	1/4"	16	400	48,0	18,0	27	30	0,154	2353-GE16SG02
schwer	3/8"	6	630	42,0	15,5	22	17	0,076	2353-GE06SG03
schwer	3/8"	8	630	43,0	15,5	22	19	0,083	2353-GE08SG03
schwer	3/8"	10	630	43,0	15,0	22	22	0,089	2353-GE10SG03
schwer	3/8"	12	630	45,0	17,0	22	24	0,100	2353-GE12SG03
schwer	3/8"	14	630	48,0	18,5	24	27	0,132	2353-GE14SG03
schwer	3/8"	16	400	48,0	18,0	27	30	0,152	2353-GE16SG03
schwer	1/2"	6	630	47,0	18,0	27	17	0,110	2353-GE06SG04
schwer	1/2"	8	630	47,0	18,0	27	19	0,123	2353-GE08SG04
schwer	1/2"	10	630	48,0	17,5	27	22	0,131	2353-GE10SG04
schwer	1/2"	12	630	48,0	17,5	27	24	0,087	2353-GE12SG04
schwer	1/2"	14	630	51,0	19,0	27	27	0,156	2353-GE14SG04
schwer	1/2"	16	400	51,0	18,5	27	30	0,164	2353-GE16SG04
schwer	1/2"	20	400	56,0	20,5	32	36	0,265	2353-GE20SG04
schwer	1/2"	25	400	59,0	22,0	36	46	0,000	2353-GE25SG04
schwer	3/4"	12	630	52,0	21,0	32	24	0,000	2353-GE12SG06
schwer	3/4"	14	630	54,0	19,0	32	27	0,000	2353-GE14SG06
schwer	3/4"	16	400	55,0	20,5	32	30	0,231	2353-GE16SG06
schwer	3/4"	20	400	58,0	20,5	32	36	0,267	2353-GE20SG06
schwer	3/4"	25	400	63,0	23,0	41	46	0,490	2353-GE25SG06
schwer	3/4"	30	400	66,0	24,0	46	50	0,000	2353-GE30SG06
schwer	1"	16	400	59,0	21,5	41	30	0,000	2353-GE16SG08
schwer	1"	20	400	62,0	22,5	41	36	0,396	2353-GE20SG08
schwer	1"	25	400	65,0	23,0	41	46	0,100	2353-GE25SG08
schwer	1"	30	400	68,0	23,5	46	50	0,616	2353-GE30SG08
schwer	1 1/4"	20	400	64,0	22,5	50	36	0,000	2353-GE20SG10
schwer	1 1/4"	30	400	70,0	23,5	50	50	0,000	2353-GE30SG10
schwer	1 1/4"	38	250	77,0	26,0	55	60	0,000	2353-GE38SG10
schwer	1 1/2"	30	400	75,0	23,5	55	50	0,878	2353-GE30SG12
schwer	1 1/2"	38	250	79,0	26,0	55	60	0,942	2353-GE38SG12

available material: 1.4571

Systems > cutting rings > straight couplings > male thread > BSPP DIN-ISO 228

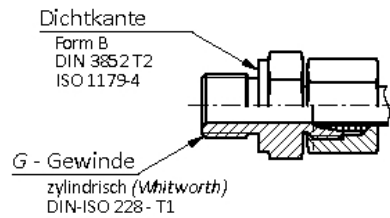
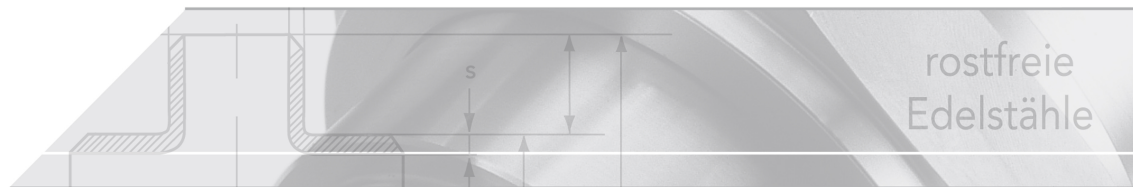

Straight threaded connection made of stainless steel
 DIN 2353, EN ISO 8341-1

Threaded studs Form B

DIN 3852 T2, ISO 1179-4
 metallic seal due to seal edge
 with cylindrical Whitworth-pipe threads ("G")
 DIN-ISO 228 -T1 or BSP-thread

Nominal pressures PN

Series	Pipe OØ	PN
L (light)	6 - 15	250
	18 - 22	160
	28 - 42	100
S (heavy)	6 - 14	630
	16 - 25	400
	30 - 38	250

The nominal pressure is a commonly used rounded-off number referring to the pressure that is listed for static loads with a 3- or 4-fold safety margin.

Pressure deductions

Temperature	Pressure deduction
+50°C	4,5%
+100°C	11%
+200°C	20%
+300°C	29%
+400°C	33%

For seal materials such as FPM and Viton, the temperature limits of -25 to +200°C must be noted.
 All values specified are guidelines that can also be influenced to a greater or lesser extent by the medium.

