

straight male stud coupling  
DIN 2353, EN ISO 8434-1  
metric thread

[short name: GE.M\\*](#)

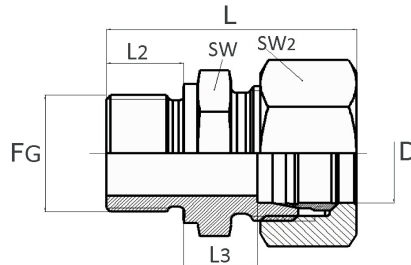

### technical product sheet

Reihe	FG	D	PN	L	L3	SW	SW2	kg	Art.-Nr.
leicht	M 8 x 1	6	315	31,0	8,5	14	14	0,000	2353-GE06LM08
leicht	M 10 x 1	6	315	31,0	8,5	14	14	0,035	2353-GE06LM10
leicht	M 10 x 1	8	315	33,0	10,0	17	18	0,038	2353-GE08LM10
leicht	M 10 x 1	10	315	33,0	12,0	17	19	0,020	2353-GE10LM10
leicht	M 10 x 1	12	315	35,0	13,0	19	22	0,000	2353-GE12LM10
leicht	M 12 x 1,5	6	315	37,0	10,0	17	14	0,033	2353-GE06LM12
leicht	M 12 x 1,5	8	315	37,0	10,0	17	17	0,039	2353-GE08LM12
leicht	M 12 x 1,5	10	315	38,0	11,0	17	19	0,000	2353-GE10LM12
leicht	M 12 x 1,5	12	315	37,0	11,5	19	22	0,059	2353-GE12LM12
leicht	M 14 x 1,5	6	315	37,0	11,0	19	17	0,000	2353-GE06LM14
leicht	M 14 x 1,5	8	315	38,0	12,0	19	19	0,047	2353-GE08LM14
leicht	M 14 x 1,5	10	315	38,0	12,0	22	20	0,051	2353-GE10LM14
leicht	M 14 x 1,5	12	315	38,0	11,0	19	22	0,069	2353-GE12LM14
leicht	M 16 x 1,5	10	315	39,0	12,0	22	19	0,064	2353-GE10LM16
leicht	M 16 x 1,5	12	315	39,0	12,5	22	22	0,069	2353-GE12LM16
leicht	M 16 x 1,5	15	315	40,0	13,0	24	27	0,000	2353-GE15LM16
leicht	M 16 x 1,5	18	315	43,0	17,0	27	32	0,146	2353-GE18LM16
leicht	M 18 x 1,5	10	315	39,0	12,5	24	19	0,000	2353-GE10LM18
leicht	M 18 x 1,5	12	315	41,0	13,5	24	26	0,076	2353-GE12LM18
leicht	M 18 x 1,5	15	315	41,0	13,5	24	24	0,101	2353-GE15LM18
leicht	M 18 x 1,5	18	315	42,0	14,0	27	32	0,000	2353-GE18LM18
leicht	M 20 x 1,5	10	315	42,0	14,5	27	19	0,098	2353-GE10LM20
leicht	M 22 x 1,5	15	315	44,0	15,0	27	27	0,142	2353-GE12LM22
leicht	M 22 x 1,5	15	315	44,0	15,0	27	27	0,126	2353-GE15LM22
leicht	M 22 x 1,5	18	315	45,0	14,5	27	32	0,789	2353-GE18LM22
leicht	M 22 x 1,5	22	160	47,0	16,5	32	36	0,194	2353-GE22LM22
leicht	M 26 x 1,5	18	315	47,0	18,0	32	32	0,000	2353-GE18LM26
leicht	M 26 x 1,5	22	160	49,0	16,5	32	36	0,194	2353-GE22LM26
leicht	M 33 x 2	28	160	52,0	17,5	41	41	0,000	2353-GE22LM33
leicht	M 33 x 2	28	160	52,0	17,5	41	41	0,000	2353-GE28LM33
leicht	M 42 x 2	35	160	59,0	17,5	50	50	0,000	2353-GE42LM42
leicht	M 48 x 2	42	160	64,0	19,0	55	66	0,625	2353-GE42LM48
schwer	M 10 x 1	12	630	39,0	16,0	22	24	0,000	2353-GE12SM10
schwer	M 12 x 1,5	6	630	40,0	13,0	17	17	0,000	2353-GE06SM12
schwer	M 14 x 1,5	6	630	42,0	15,0	19	17	0,000	2353-GE06SM14
schwer	M 14 x 1,5	8	630	42,0	15,0	19	19	0,067	2353-GE08SM14

Reihe	FG	D	PN	L	L3	SW	SW2	kg	Art.-Nr.
schwer	M 14 x 1,5	12	630	45,0	16,5	22	24	0,000	2353-GE12SM14
schwer	M 16 x 1,5	6	630	42,0	15,0	22	17	0,073	2353-GE06SM16
schwer	M 16 x 1,5	10	630	43,0	15,0	22	22	0,000	2353-GE08SM16
schwer	M 16 x 1,5	10	630	43,0	15,0	22	22	0,000	2353-GE10SM16
schwer	M 16 x 1,5	12	630	43,0	15,0	22	24	0,000	2353-GE12SM16
schwer	M 18 x 1,5	10	630	45,0	17,0	24	22	0,000	2353-GE10SM18
schwer	M 18 x 1,5	12	630	45,0	17,0	24	24	0,000	2353-GE12SM18
schwer	M 18 x 1,5	14	630	47,0	19,0	24	27	0,000	2353-GE14SM18
schwer	M 20 x 1,5	12	630	36,0	18,0	27	24	0,139	2353-GE12SM20
schwer	M 22 x 1,5	12	630	48,0	17,5	27	24	0,000	2353-GE12SM22
schwer	M 22 x 1,5	14	630	50,0	19,0	27	27	0,000	2353-GE14SM22
schwer	M 22 x 1,5	16	400	51,0	18,5	27	30	0,172	2353-GE16SM22
schwer	M 22 x 1,5	20	400	55,0	20,0	32	36	0,000	2353-GE20SM22
schwer	M 27 x 2	16	400	54,0	20,0	32	30	0,000	2353-GE16SM27
schwer	M 27 x 2	20	400	58,0	20,5	32	36	0,000	2353-GE20SM27
schwer	M 27 x 2	25	400	62,0	23,0	41	46	0,000	2353-GE25SM27
schwer	M 33 x 2	25	400	65,0	23,0	41	46	0,000	2353-GE25SM33
schwer	M 42 x 2	30	400	70,0	23,5	50	50	0,000	2353-GE25SM42
schwer	M 42 x 2	30	400	73,0	23,5	50	50	0,686	2353-GE30SM42
schwer	M 48 x 2	30	250	79,0	26,0	55	60	0,000	2353-GE30SM48

available material: 1.4571

Systems > cutting rings > straight couplings > male thread > metric

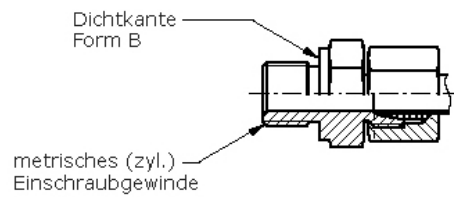
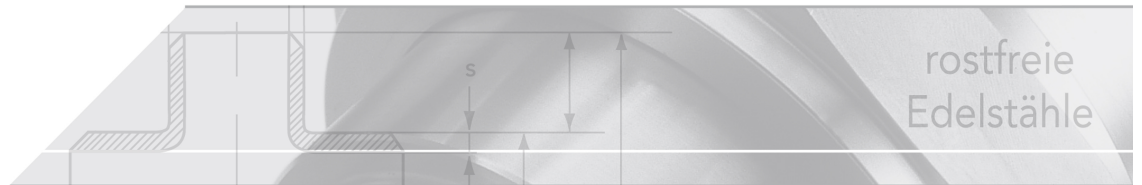

Straight threaded connection made of stainless steel  
 DIN 2353, EN ISO 8341-1

### Threaded studs Form B

DIN 3852 T2, ISO 1179-4

metallic seal due to seal edge

metric DIN-ISO-thread (cylindrical)

DIN 13 - T5 - T7, ISO 261, ISO 724

### Nominal pressures PN

Series	Pipe outsideØ	PN
L (light)	6 - 15	250
	18 - 22	160
	28 - 42	100
S (heavy)	6 - 14	630
	16 - 25	400
	30 - 38	250

The nominal pressure is a commonly used rounded-off number referring to the pressure that is listed for static loads with a 3- or 4-fold safety margin.

### Pressure deductions

Temperature	Pressure deductions
+50°C	4,5%
+100°C	11%
+200°C	20%
+300°C	29%
+400°C	33%

For seal materials such as FPM and Viton, the temperature limits of -25 to +200°C must be noted.

All values specified are guidelines that can also be influenced to a greater or lesser extent by the medium.

