

hygiene-flange connection

[short name: HFV*](#)

DIN 11853-2 (short)

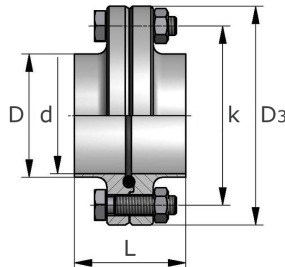

technical product sheet

Anschl.	DN	D	s	D3	L	k	Schraube	DW	kg
DIN	10	13,0	1,5	54	48	37	4x M8 x 30	EPDM	0,310
DIN	15	19,0	1,5	59	48	42	4x M8 x 30	EPDM	0,370
DIN	20	23,0	1,5	64	48	47	4x M8 x 30	EPDM	0,430
DIN	25	29,0	1,5	70	48	53	4x M8 x 30	EPDM	0,500
DIN	32	35,0	1,5	76	48	59	4x M8 x 30	EPDM	0,570
DIN	40	41,0	1,5	82	48	65	4x M8 x 30	EPDM	0,640
DIN	50	53,0	1,5	94	48	77	4x M8 x 30	EPDM	0,780
DIN	65	70,0	2,0	113	48	95	8x M8 x 30	EPDM	1,086
DIN	80	85,0	2,0	133	52	112	8x M10 x 35	EPDM	1,590
DIN	100	104,0	2,0	159	52	137	8x M10 x 40	EPDM	2,560
DIN	125	129,0	2,0	183	56	161	8x M10 x 40	EPDM	3,060
DIN	150	154,0	2,0	213	56	188	8x M12 x 50	EPDM	4,344
ISO	10	17,2	1,6	59	48	42	4x M8 x 30	EPDM	0,370
ISO	15	21,3	1,6	62	48	45	4x M8 x 30	EPDM	0,410
ISO	20	26,9	1,6	69	48	52	4x M8 x 30	EPDM	0,500
ISO	25	33,7	2,0	74	48	57	4x M8 x 30	EPDM	0,560
ISO	32	42,4	2,0	82	48	65	4x M8 x 30	EPDM	0,650
ISO	40	48,3	2,0	88	48	71	4x M8 x 30	EPDM	0,730
ISO	50	60,3	2,0	103	48	85	4x M8 x 30	EPDM	0,940
ISO	65	76,1	2,0	125	48	104	8x M10 x 30	EPDM	1,400
ISO	80	88,9	2,3	137	52	137	8x M10 x 35	EPDM	1,690
ISO	100	114,3	2,3	168	52	146	8x M10 x 35	EPDM	2,790

available material: ask

Systems > DIN 11864/ DIN 11853 > flange connections > hygiene DIN 11853-2 > complete connections

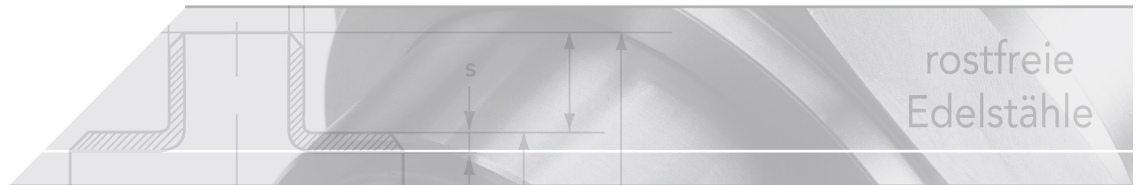

Aseptic-flange connection DIN 11864-2, Shape A

> Fields of application

The aseptic and hygiene flange connections according to DIN 11853-2 are compatible and differ only in terms of the axial length. They are used for processing systems for liquid media with high purity requirements. Popular areas of application are the biotechnology, cosmetics, chemical, pharmaceutical, and food and beverage industries.

> Installation

The O-ring is inserted in the groove flange during installation, which automatically holds the O-ring in place. The collar flange is then placed against it so that both flanges engage each other. The flanges and the O-ring are therefore coaxially centered. After that, the screws are inserted through the holes drilled in the flanges so that the heads of the screws are on the outer surface of one flange and the threads of the screws stick out of the other flange. The nuts are screwed onto these threads and evenly tightened until the faces of the flanges come into contact with each other. The O-ring is deformed by this so that a smooth passage free of dead space and a sealed connection are produced.

> Operating pressure (at 140°C)

Tube-OØ	bar
till 41 mm	max. 25 bar
42,4 - 101,6 mm	max. 16 bar
104,0 - 154,0 m	max. 10 bar

when suitable seals are used