

grooved flange DIN 11853-2

[short name: HNF*](#)

short, design A

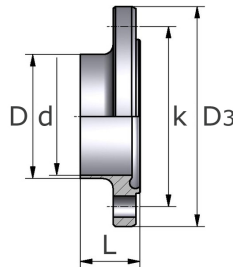

technical product sheet

Anschl.	DN	D	s	d	k	D3	L	kg
DIN	10	13,0	1,5	10,0	37	54	25,5	0,160
DIN	15	19,0	1,5	16,0	42	59	25,5	0,190
DIN	20	23,0	1,5	20,0	47	64	25,5	0,220
DIN	25	29,0	1,5	26,0	53	70	25,5	0,255
DIN	32	35,0	1,5	32,0	59	76	25,5	0,290
DIN	40	41,0	1,5	38,0	65	82	25,5	0,330
DIN	50	53,0	1,5	50,0	77	94	25,5	0,385
DIN	65	70,0	2,0	66,0	95	113	25,5	0,530
DIN	80	85,0	2,0	81,0	112	133	27,5	0,828
DIN	100	104,0	2,0	100,0	137	159	27,5	1,300
DIN	125	129,0	2,0	125,0	161	183	29,5	1,550
DIN	150	154,0	2,0	150,0	188	213	29,5	2,200
ISO	10	17,2	1,6	14,0	42	59	25,5	0,190
ISO	15	21,3	1,6	18,1	45	62	25,5	0,200
ISO	20	26,9	1,6	23,7	52	69	25,5	0,250
ISO	25	33,7	2,0	29,7	57	74	25,5	0,290
ISO	32	42,4	2,0	38,4	65	82	25,5	0,330
ISO	40	48,3	2,0	44,3	71	88	25,5	0,370
ISO	50	60,3	2,0	56,3	85	103	25,5	0,480
ISO	65	76,1	2,0	72,1	104	125	25,5	0,760
ISO	80	88,9	2,3	84,3	116	137	27,5	0,860
ISO	100	114,0	2,3	109,7	146	168	27,5	1,390

available material: ask

Systems > DIN 11864/ DIN 11853 > flange connections > hygiene DIN 11853-2 > grooved flanges

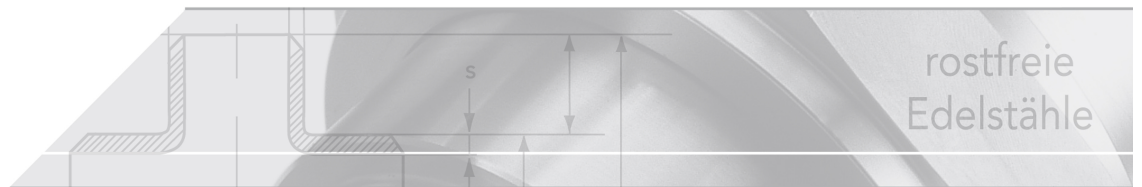

Weld-on grooved flange

Aseptic-flange connection DIN 11864-2, Shape A

> Fields of application

The aseptic and hygiene flange connections according to DIN 11853-2 are compatible and differ only in terms of the axial length. They are used for processing systems for liquid media with high purity requirements. Popular areas of application are the biotechnology, cosmetics, chemical, pharmaceutical, and food and beverage industries.

> Installation

The O-ring is inserted in the groove flange during installation, which automatically holds the O-ring in place.

The collar flange is then placed against it so that both flanges engage each other.

The flanges and the O-ring are therefore coaxially centered. After that, the screws are inserted through the holes drilled in the flanges so that the heads of the screws are on the outer surface of one flange and the threads of the screws stick out of the other flange. The nuts are screwed onto these threads and evenly tightened until the faces of the flanges come into contact with each other. The O-ring is deformed by this so that a smooth passage free of dead space and a sealed connection are produced.

> Operating pressure (bei 140°C)

Tube-OØ	bar
till 41 mm	max. 25 bar
42,4 - 101,6 mm	max. 16 bar
114,3 - 154,0 m	max. 10 bar

when suitable seals are used

