

redukční šroubení T  
DIN 2353, těžká série

[zkratka označení: TR.S\\*](#)

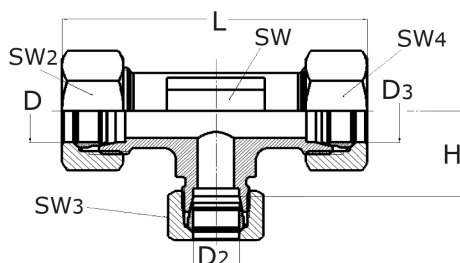

### technický list výrobku

	Reihe	D	D2	D3	L	H	SW	SW2	SW3	SW4	kg	Art.-Nr.
	schwer	12	6	12	73	22,5	17	22	24	24	0,0002353	TR101212S
	schwer	12	6	12	77	21,5	20	24	17	24	0,0002353	TR120612S
	schwer	12	8	12	76	22,5	17	24	19	24	0,0002353	TR120812S
	schwer	12	10	12	77	24,5	24	24	30	24	0,0002353	TR121012S
	schwer	12	16	12	77	24,5	24	24	30	24	0,0002353	TR121612S
	schwer	14	10	14	78	21,0	19	21	22	27	0,0002353	TR141014S
	schwer	16	10	16	84	24,0	19	27	22	27	0,0002353	TR161016S
	schwer	16	12	12	81	22,5	24	30	24	24	0,0002353	TR161212S
	schwer	16	12	16	85	25,0	24	30	24	30	0,0002353	TR161216S
	schwer	16	14	16	86	25,5	24	30	27	30	0,0002353	TR161416S
	schwer	16	16	12	81	22,0	24	30	30	24	0,0002353	TR161612S
	schwer	16	16	20	95	26,5	27	30	30	36	0,0002353	TR161620S
	schwer	16	16	25	106	30,5	36	30	30	46	0,0002353	TR161625S
	schwer	16	20	16	92	26,5	27	30	36	30	0,0002353	TR162016S
	schwer	16	25	16	102	30,0	36	30	46	30	0,0002353	TR162516S
	schwer	20	8	20	94	29,5	27	36	19	36	0,0002353	TR200820S
	schwer	20	12	20	95	27,5	27	36	24	36	0,0002353	TR201220S
	schwer	20	16	20	95	26,5	27	36	30	36	0,0002353	TR201620S
	schwer	20	25	20	105	30,5	36	36	46	36	0,0002353	TR202520S
	schwer	25	10	25	108	30,0	36	46	22	46	0,0002353	TR251025S
	schwer	25	16	25	106	27,5	36	46	30	46	0,0002353	TR251625S
	schwer	25	20	25	106	25,5	36	46	36	46	0,0002353	TR252025S
	schwer	25	25	16	106	29,5	36	46	46	30	0,0002353	TR252516S
	schwer	30	10	20	96	31,0	27	36	22	36	0,0002353	TR301020S
	schwer	30	16	30	123	37,5	41	50	30	46	0,0002353	TR301630S
	schwer	30	20	30	123	37,5	41	50	36	46	0,0002353	TR302030S
	schwer	30	25	25	123	37,5	41	50	46	46	0,0002353	TR302525S
	schwer	30	25	30	123	37,5	41	50	46	46	0,0002353	TR302530S
	schwer	38	20	38	141	43,0	50	60	36	60	0,0002353	TR382038S
	schwer	38	30	38	141	43,0	50	60	50	60	0,0002353	TR383038S
	schwer	38	38	30	141	41,0	50	60	60	50	0,0002353	TR383830S

dostupné jakosti: na poptávku

Systemy > zářezné kroužky > T-šroubení > redukce > S (těžká řada)



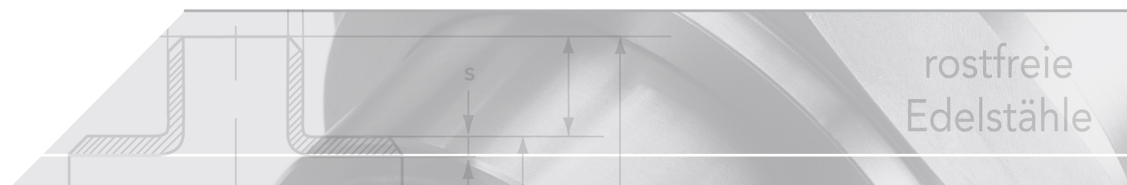

T-Reducing threaded connection made of stainless steel  
DIN 2353 heavy series

### Nominal pressures PN

Series	Pipe OØ	PN
L (light)	6 - 15	250
	18 - 22	160
	28 - 42	100
S (heavy)	6 - 14	630
	16 - 25	400
	30 - 38	250

The nominal pressure is a commonly used rounded-off number referring to the pressure that is listed for static loads with a 3- or 4-fold safety margin.