

Einschraub-Winkel, konisch IG
für Verschraubung ISO 4144

[short name: VKWI.I*](#)

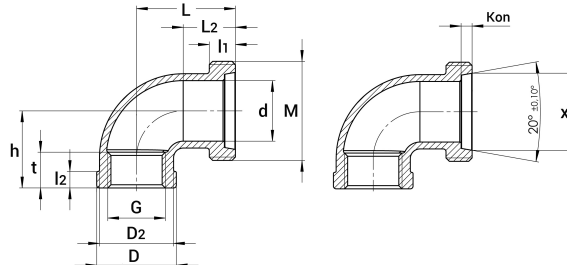

technical product sheet

G	t	l2	d	L	L2	h	D	D2	M	l1	Kon	x	Art.-Nr.
1/2"	13	6	22,0	36,0	19,0	28	29	27	M36x2	9,5	4,0	28,0	VKWI-012-I
3/4"	14	6	28,0	41,5	21,0	33	36	34	M42x2	9,5	4,0	33,0	VKWI-034-I
1"	16	6	34,0	44,5	20,5	38	44	41	M48x2	11,5	4,0	39,5	VKWI-100-I
1 1/4"	16	7	44,0	55,0	25,0	45	54	51	M58x2	13,0	4,5	49,5	VKWI-114-I
1 1/2"	16	7	50,0	60,5	25,5	50	60	57	M65x2	13,5	4,5	55,0	VKWI-112-I
2"	21	7	61,0	63,5	20,5	58	73	70	M80x2	20,5	4,5	68,0	VKWI-200-I

available material: ask

Gewindefittings > Verschraubungen > konisch dichtend > PN 20 (ISO 4144) > Wissenswertes > Einzelteile > Einschraub-Winkel - IG

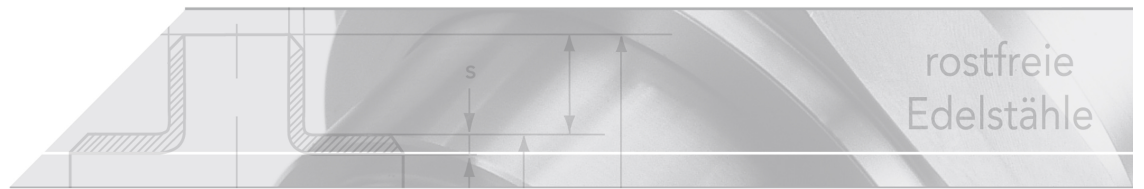

konisch dichtend (20° - Konus)