

blank liner, no. 218

[short name: 218*](#)

DIN 11851

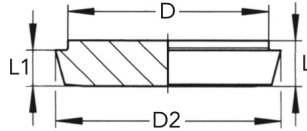

technical product sheet

DN	D	D2	L	L1	kg	Art.-Nr.
10	18	22	9	6	0,031	GL-218-010
15	24	28	9	6	0,040	GL-218-015
20	30	36	11	8	0,078	GL-218-020
25	35	44	13	10	0,130	GL-218-025
32	41	50	13	10	0,176	GL-218-032
40	48	56	13	10	0,220	GL-218-040
50	61	68	14	11	0,360	GL-218-050
65	79	86	16	12	0,671	GL-218-065
80	93	100	16	12	0,920	GL-218-080
100	114	121	20	15	1,710	GL-218-100
125	137	150	23	17	2,840	GL-218-125
150	163	176	24	18	4,300	GL-218-150

available material: V4A

Beverage fittings > unions > liners > blank > solid material



Blank liner

for the food industry

Materials

V2A

AISI 304/ 304L - 1.4301/ 1.4306, 1.4307

V4A

AISI 316L - 1.4404