

redukce s násuvným koncem  
lisovací fitinka, M profil

[zkratka označení: N.14BIG\\*](#)

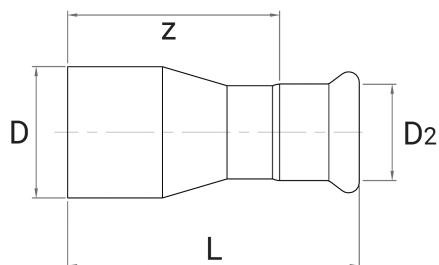

#### technický list výrobku

Rohr-AD	D	D2	s	L	Z	DW
139,7 x 88,9	139,7	88,9	2,0	340	282	EPDM
139,7 x 108	139,7	108,0	2,0	307	236	EPDM
168,3 x 88,9	168,3	88,9	2,0	379	321	EPDM
168,3 x 108	168,3	108,0	2,0	360	289	EPDM
168,3 x 139,7	168,3	139,7	2,0	422	324	EPDM

dostupné jakosti: na poptávku

Systeme > Pressfittings > BIG PRESS > Reduzierstück

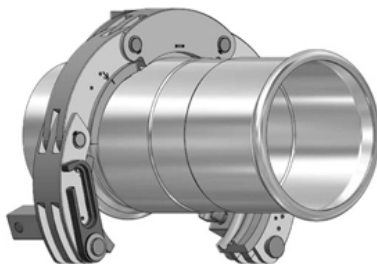

## NUMEPRESS

Stainless steel press-system

### Properties

Unsolvable press connection acc. to EN 10088

M profile, system independent

Nominal pressure for water applications max. 16 bar

Stainless steel 1.4404 (AISI 316L)

DVGW-approval for water

ÖVGW-certificate for water installations

SVGW SSIIG - certificate for water distribution systems

FM APPROVED

### Gaskets

Material	Colour	Application	Temperature
EPDM	black	water	-20° - +110° C
FKM	green	solar, oil, compressed ai	-30° - +180° C
FPM	red	steam	-20° - +200° C

